

A.E. Hodsdon Engineers
10 Common Street
Waterville, Maine 04901

Request for Proposals
for the Building Demolition Services
for the Town of New Sharon
New Sharon, Maine

Letter of Clarification
February 24, 2020

The following is a clarification regarding the RFP for the Building Demolition Services.

1. As shown on the Revised Plan, a portion of the slab needed to remain intact as it will be used for the floor of the new Town Office. The original plan called for approximately 60 x 60 section of slab to remain intact. The new amount to remain intact shall be 60 x 84.

End of Letter of Clarification

FILE LOCATION: N:\CAD\Land Projects\2019\27-19 New Sharon Structural\dwg\Old 2006 Drawings\27-19 Town Office Plans 1.dwg / SAVED BY: MARK / FILE SIZE: 1.66MB / DATE: 2/24/2020 12:02 PM

EXISTING NEW SHARON MUNICIPAL BUILDING

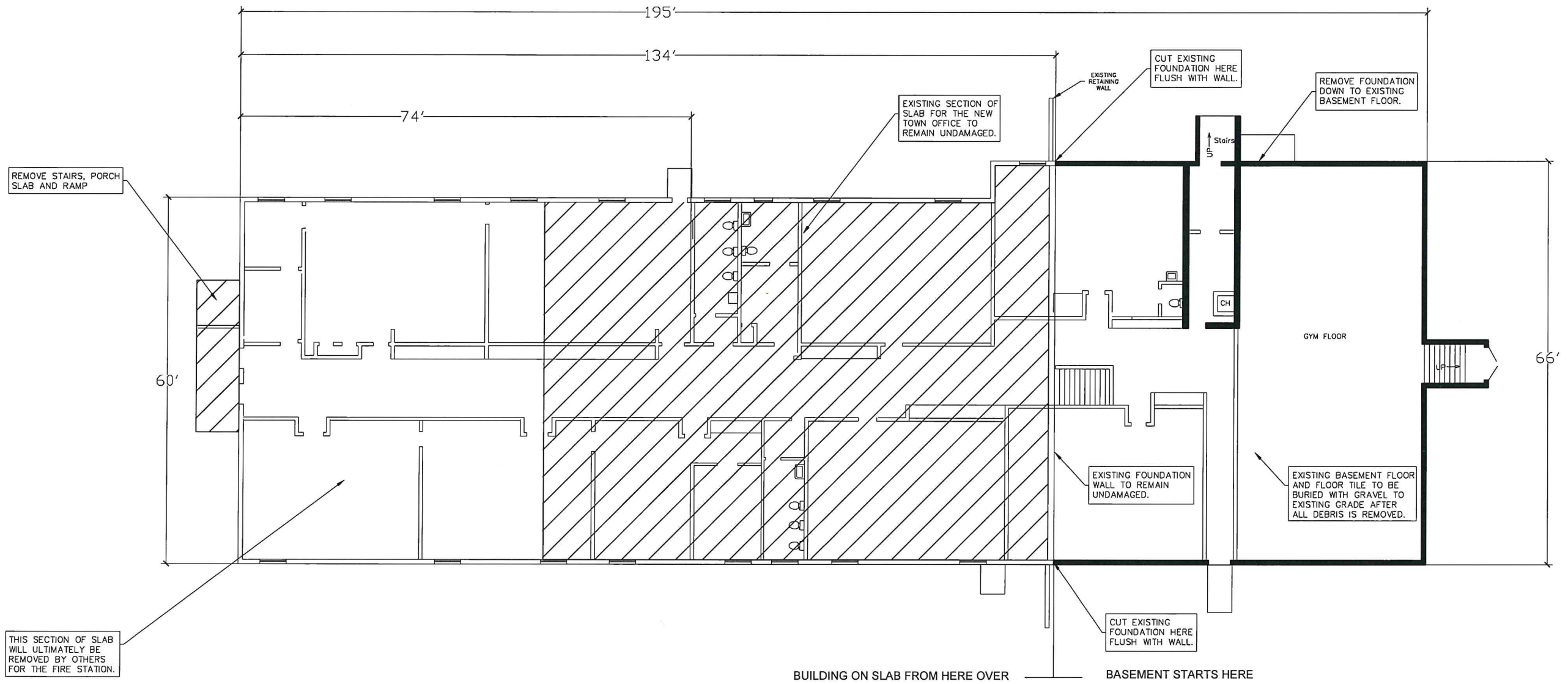

REMOVE STAIRS, PORCH SLAB AND RAMP

THIS SECTION OF SLAB WILL ULTIMATELY BE REMOVED BY OTHERS FOR THE FIRE STATION.

REMOVE ENTIRE BUILDING FROM FOUNDATION. FOUNDATION AROUND SLAB PORTION OF BUILDING SHALL BE REUSED FOR NEW BUILDING AND MUST NOT BE DAMAGED.

EXISTING SECTION OF SLAB FOR THE NEW TOWN OFFICE TO REMAIN UNDAMAGED.

CUT EXISTING FOUNDATION HERE FLUSH WITH WALL.

REMOVE FOUNDATION DOWN TO EXISTING BASEMENT FLOOR.

EXISTING FOUNDATION WALL TO REMAIN UNDAMAGED.

EXISTING BASEMENT FLOOR AND FLOOR TILE TO BE BURIED WITH GRAVEL TO EXISTING GRADE AFTER ALL DEBRIS IS REMOVED.

CUT EXISTING FOUNDATION HERE FLUSH WITH WALL.

1	REVISED SQ.FT. OF SLAB TO BE LEFT INTACT	2/24/20	
	ISSUE FOR BID	2/11/20	
No.	Revisions	Date	App'd.
NEW MUNICIPAL BUILDING			
11 SCHOOL LANE NEW SHARON, MAINE			
DEMOLITION PLAN			
AEHodsdon CONSULTING ENGINEERS 10 Common St. Waterville, Me. 04901 (207) 873-5164			Sheet No.
Drawn By: MEM Scale: AS SHOWN Checked By: MJD Date: 02/11/2020 Approved By: AEH Date: 02/11/2020			1
File No. 27-19 Town Office Plans 1.dwg Project No. 27-19			Of 1